

Zeichenerklärung

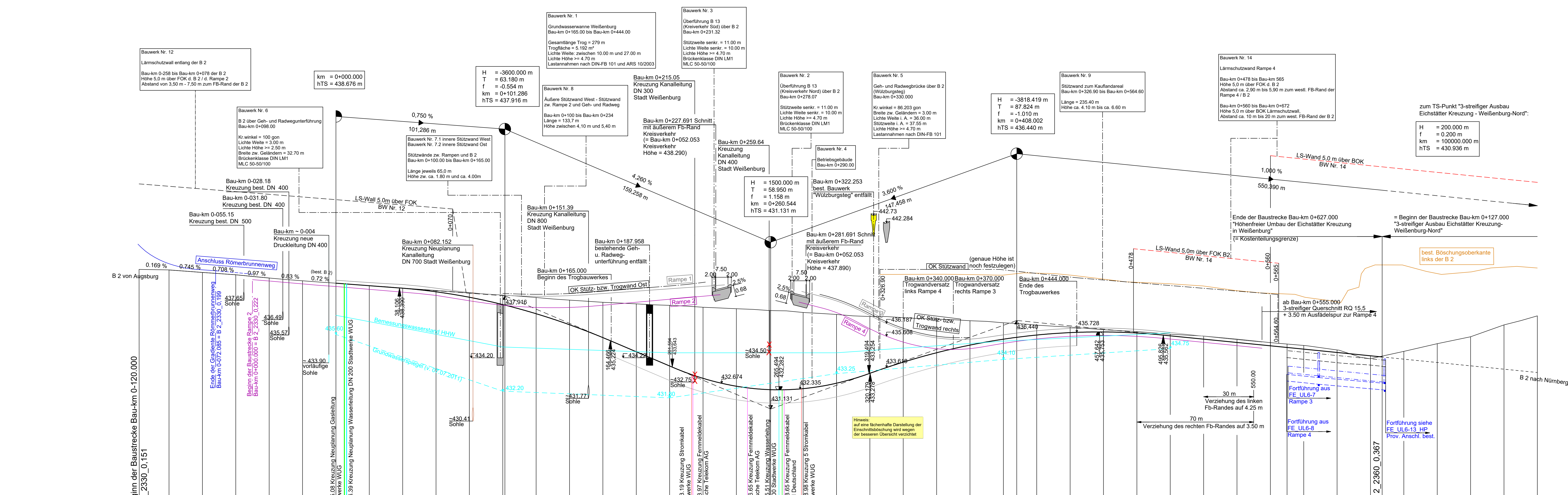
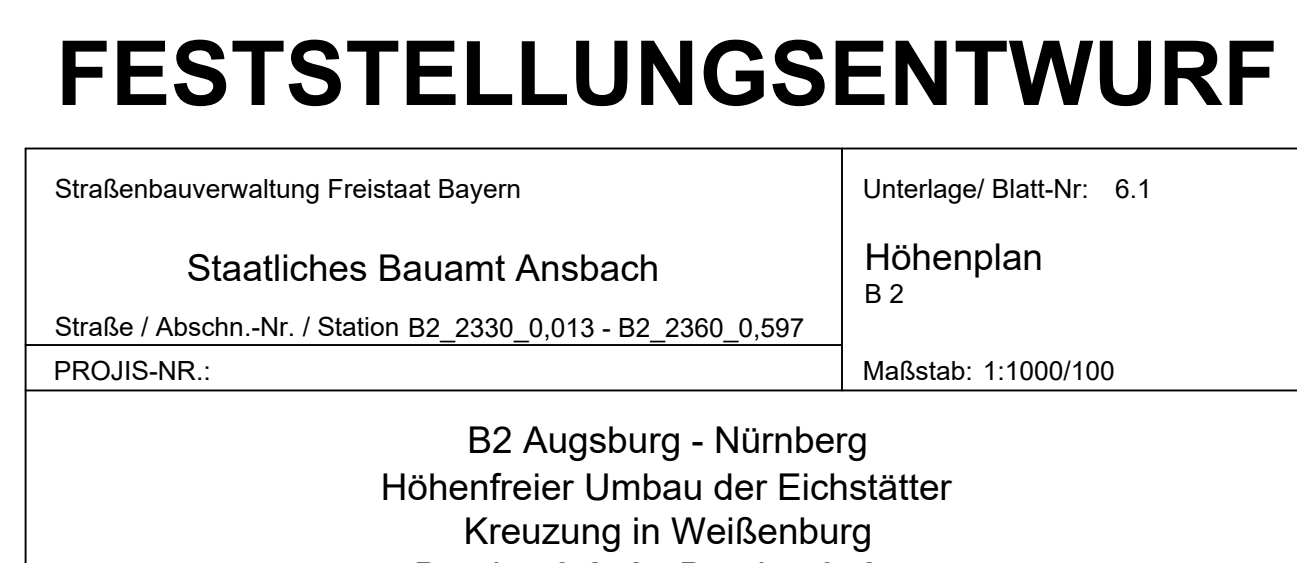
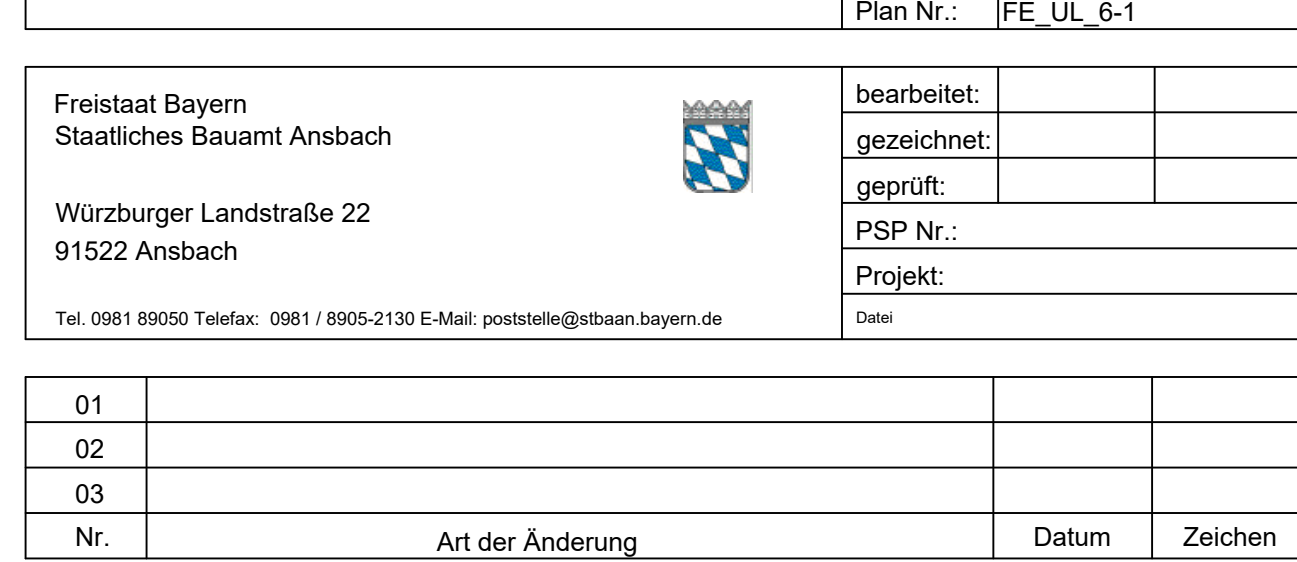
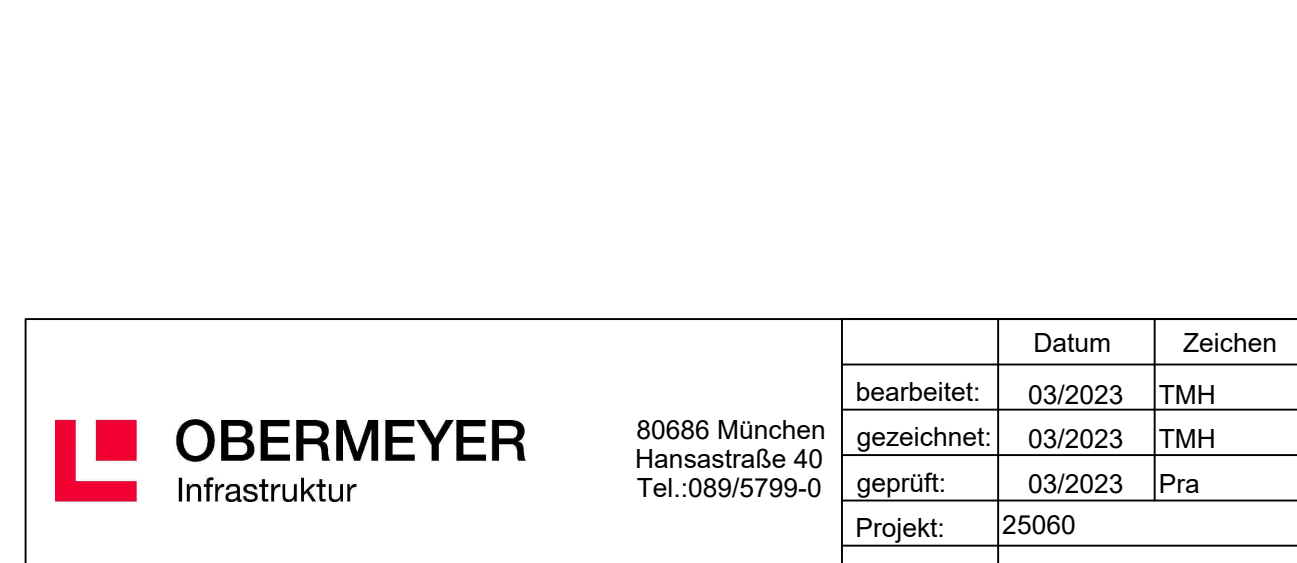
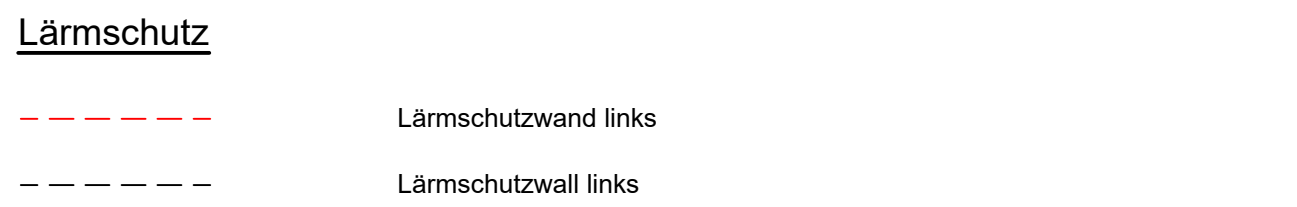
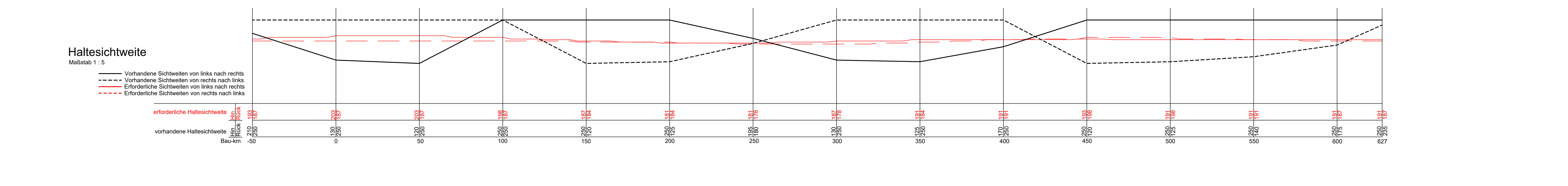
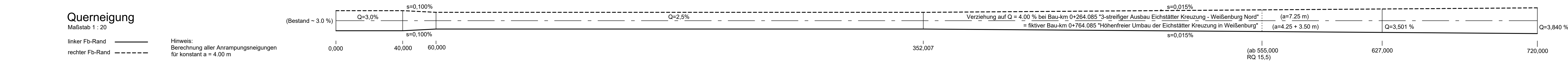
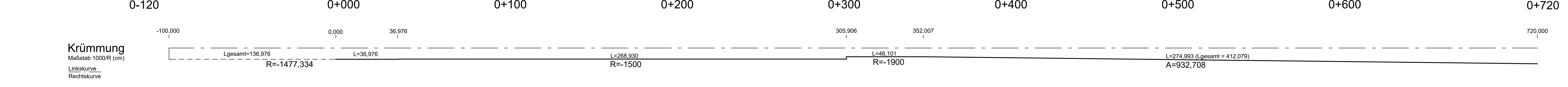

Table with 5 columns: Station, Gradient height, Ground height, Left drainage, Right drainage, and Station gradient. It contains numerical data for each station along the route.



Project information block including the name of the engineering firm (OBERMEYER Infrastruktur), address, and contact details.

Approval stamp from the State Building Authority (Staatliches Bauamt Ansbach) with date and signature.

Revision table with columns for number, description of changes, date, and signature.

FESTSTELLUNGSENTWURF

Project title block containing the name of the project (B2 Augsburg - Nürnberg), location, and drawing number.

Approval stamp from the State Building Authority (Staatliches Bauamt Ansbach) with date and signature.